

MVL-HY-x-1x0 Series MV 1/2" Telecentric Lenses

- Telecentric Lenses
- 1/2" (8 mm) Sensors
- C-Mount
- Variety of Amplification Factors Available

Hikvision's MVL-HY-x-1x0 Series of telecentric lenses offer high quality 1/2" (8 mm) sensors in a variety of amplification factors for any machine vision use.

Available Models:

MVL-HY-1-110:	1.000 amplification factor
MVL-HY-2-110:	2.000 amplification factor
MVL-HY-4-110:	4.000 amplification factor
MVL-HY-5-110:	.500 amplification factor
MVL-HY-08-130:	.800 amplification factor
MVL-HY-15-110:	1.50 amplification factor



Specifications

	MVL-HY-1-110	MVL-HY-2-110	MVL-HY-4-110	MVL-HY-5-110	MVL-HY-08-130	MVL-HY-15-110
Amplification Factor	1.000	2.000	4.000	0.500	0.800	1.500
Object NA	0.0255	0.026	0.055	0.0132	0.0168	0.056
Image Format	Φ1/2" (Φ8 mm)					
TV Distortion	0.001	0.002	0.001	0.005	0.001	0.001
Lamp Connector	-					
Operating Temperature	14° to 122° F (-10° to 50° C)					
Field of View D/H/V	1/3"	6 mm/4.8 mm/3.6 mm	3 mm/2.4 mm/1.8 mm	1.5 mm/1.2 mm/0.9 mm	12 mm/9.6 mm/7.2 mm	7.5 mm/6.0 mm/4.5 mm
	1/2"	8 mm/6.4 mm/4.8 mm	4 mm/3.2 mm/2.4 mm	2 mm/1.6 mm/1.2 mm	16 mm/12.8 mm/9.6 mm	10 mm/8.0 mm/6.0 mm
Specification	Macro-fixed-time lens					
Mount	C-mount					
Telecentricity	0.1°		NA	0.1°		NA
Flange Length	.69 in (17.526 mm)					
Working Distance	4.331 in (110 mm)				5.118 in (130 mm)	4/331 om (110 mm)
Dimensions	Φ0.706 x 4.323 in	Φ0.630 x 0.170 in	Φ0.630 x 5.217 in	Φ0.630 x 1.819 in	Φ0.630 x 3.823 in	Φ0.630 x 3.945 in
	(Φ18 x 109.8 mm)	(Φ16 x 73.8 mm)	(Φ16 x 132.5 mm)	(Φ16 x 46.2 mm)	(Φ18 x 97.1 mm)	(Φ16 x 100.2 mm)
Object to Image Distance	Φ9.435 in (237.326 mm)	7.926 in (201.326 mm)	10.237 in (260.026 mm)	8.840 in (173.726 mm)	9.631 in (244.626 mm)	8.966 in (227.726 mm)

Dimensions

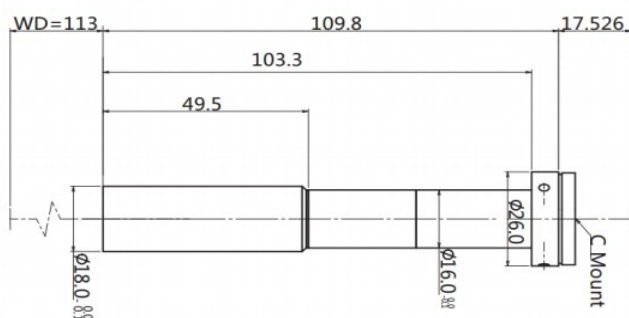

MVL-HY-1-110

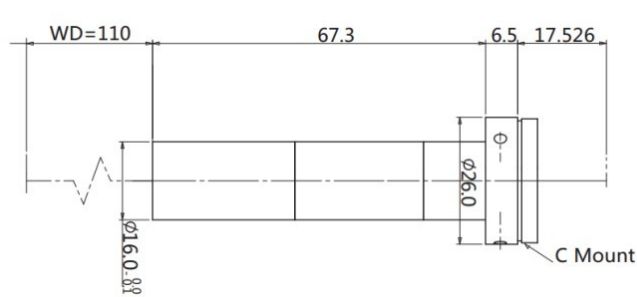

MVL-HY-2-110

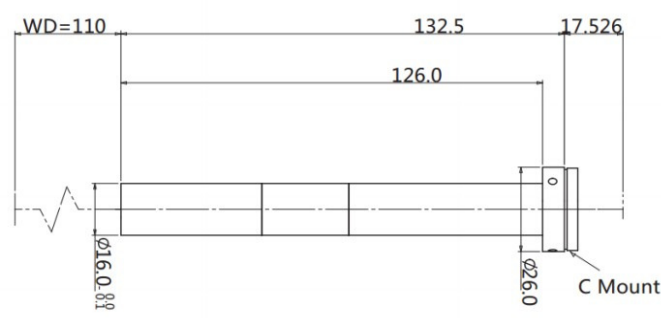

MVL-HY-4-110

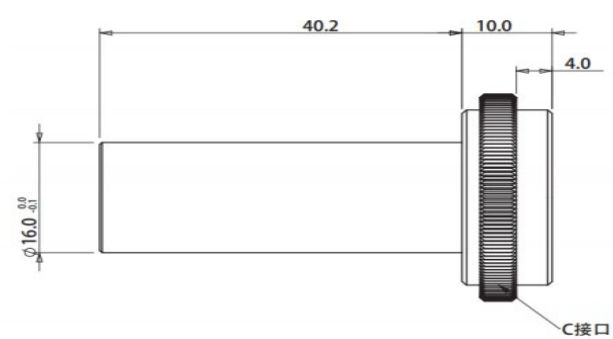

MVL-HY-5-110

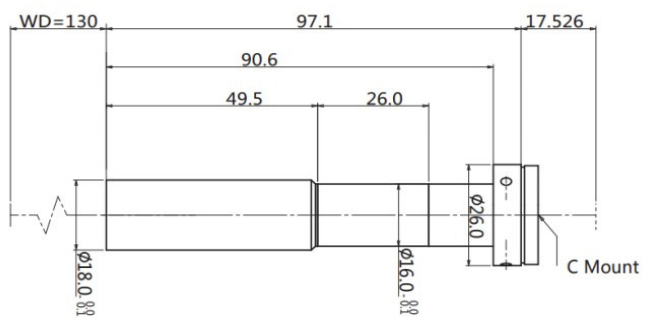

MVL-HY-08-130

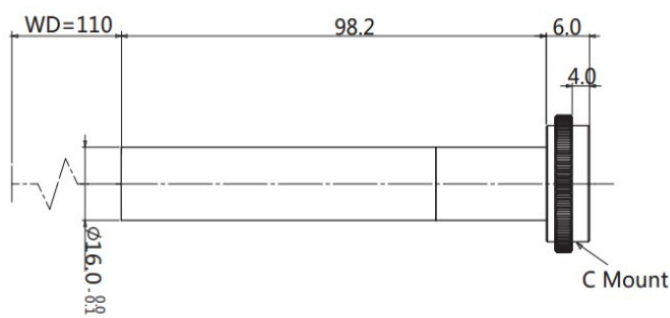

MVL-HY-15-110