

# MV-CH310-10XM-F-NF

31 MP CMOS CoaXPress Area Scan Camera



GEN*<i>i>*CAM

CoaXPress®

## Introduction

MV-CH310-10XM-F-NF camera adopts Sony IMX 342 sensor and provides high quality image. It transmits data via CXP-6 interface. With high dynamic range and high signal-noise ratio, it is widely applied to PCB AOI, FPD, high-accuracy measurement, etc.

## Key Feature

- Resolution 6464 × 4852, and pixel size 3.45 μm × 3.45 μm
- Adopts CMOS global shutter to provide high dynamic range, SNR and high quality image
- Adopts CXP-6 interface to transmit data
- Compatible with CoaXPress Protocol, and GenICam standard

## Dimension

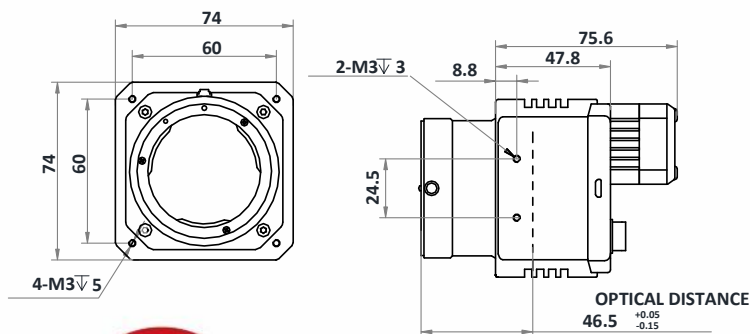

## Available Model

Mono camera: MV-CH310-10XM-F-NF

## Applicable Industry

PCB AOI, FPD, high-accuracy measurement, railway related application, etc.

## Sensor Quantum Efficiency

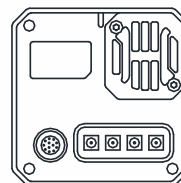
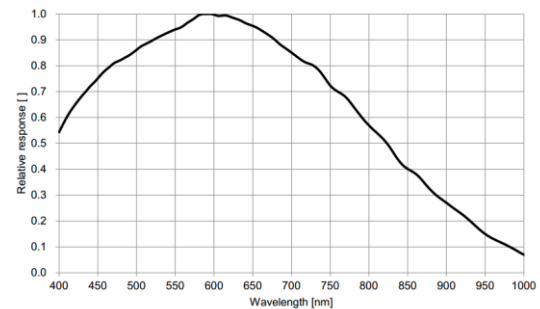

Unit: mm



## Specification

<b>Model</b>	<b>MV-CH310-10XM-F-NF</b>
<b>Camera</b>	
<b>Sensor type</b>	CMOS, global shutter
<b>Sensor model</b>	Sony IMX 342
<b>Pixel size</b>	3.45 $\mu\text{m}$ $\times$ 3.45 $\mu\text{m}$
<b>Sensor size</b>	APS-C
<b>Resolution</b>	6464 $\times$ 4852
<b>Max. frame rate</b>	ADC 8bit mode: 17.9 fps @6464 $\times$ 4852 ADC 12bit mode: 12.1 fps @6464 $\times$ 4852
<b>Mono/color</b>	Mono
<b>Pixel format</b>	ADC 8bit mode: Mono 8; ADC 12bit mode: Mono 8 / 10/ 12
<b>Dynamic range</b>	73 dB
<b>SNR</b>	40 dB
<b>Gain</b>	0 dB to 20 dB
<b>Exposure time</b>	UltraShort exposure mode: 3 $\mu\text{s}$ to 33 $\mu\text{s}$
	ADC 8bit mode: 47 $\mu\text{s}$ to 2 s
	ADC 12bit mode: 36 $\mu\text{s}$ to 2 s
<b>Shutter mode</b>	Off/ Once /Continuous exposure mode
<b>Reverse image</b>	Supports horizontal and vertical reverse image output
<b>Electrical features</b>	
<b>Data interface</b>	CoaXPress (DIN interface)
<b>Digital I/O</b>	12-pin I/O interface; opto-isolated input x1 (Line 0), opto-isolated output x1 (Line 1), bi-directional non-isolated I/O x 1 (Line 2), RS-232 x1, and RS-485 interface x 1
<b>Power supply</b>	9 VDC to 26 VDC
<b>Power consumption</b>	< 9.1 W@12 VDC
<b>Structure</b>	
<b>Lens mount</b>	F-Mount, optical back focal length 46.5 mm (1.8")
<b>Dimension</b>	74 mm $\times$ 74 mm $\times$ 75.6 mm (2.9" $\times$ 2.9" $\times$ 3.0")
<b>Weight</b>	Approx. 650 g (1.4 lb.)
<b>Ingress protection</b>	IP 40 (under proper lens installation and wiring)
<b>Temperature</b>	Working temperature: 0 $^{\circ}\text{C}$ to 50 $^{\circ}\text{C}$ (32 $^{\circ}\text{F}$ to 122 $^{\circ}\text{F}$ )
	Storage temperature: -30 $^{\circ}\text{C}$ to 70 $^{\circ}\text{C}$ (-22 $^{\circ}\text{F}$ to 158 $^{\circ}\text{F}$ )
<b>Humidity</b>	20% to 95% RH, without condensation
<b>General</b>	
<b>Client software</b>	Frame grabber software meeting with CoaXPress Protocol
<b>Operating system</b>	32/64-bit Windows 7/10 with 8 GB memory or above
<b>Compatibility</b>	CoaXPress, GenICam
<b>Certification</b>	CE, FCC, RoHS

**HIKROBOT**

Hangzhou Hikrobot Technology Co., Ltd.  
No.399 Danfeng Road, Binjiang District, Hangzhou 310051, China.  
en.hikrobotics.com

Copyright Hikrobot

Hangzhou Hikrobot Technology Co., Ltd. All Rights Reserved. Hangzhou Hikrobot Technology does not tolerate any infringement. Any organization or individual may not imitate or reproduce in whole or in part of the content. The data herein is based on Hikrobot's internal evaluation. Actual data may vary depending on specific configuration and operating condition. The information herein is subject to change without notice. All the content has been checked conscientiously. Nevertheless, Hikrobot shall not be liable to damages resulting from errors, inconsistencies or omissions.